

WPC WALL CLADDING INSTALLATION

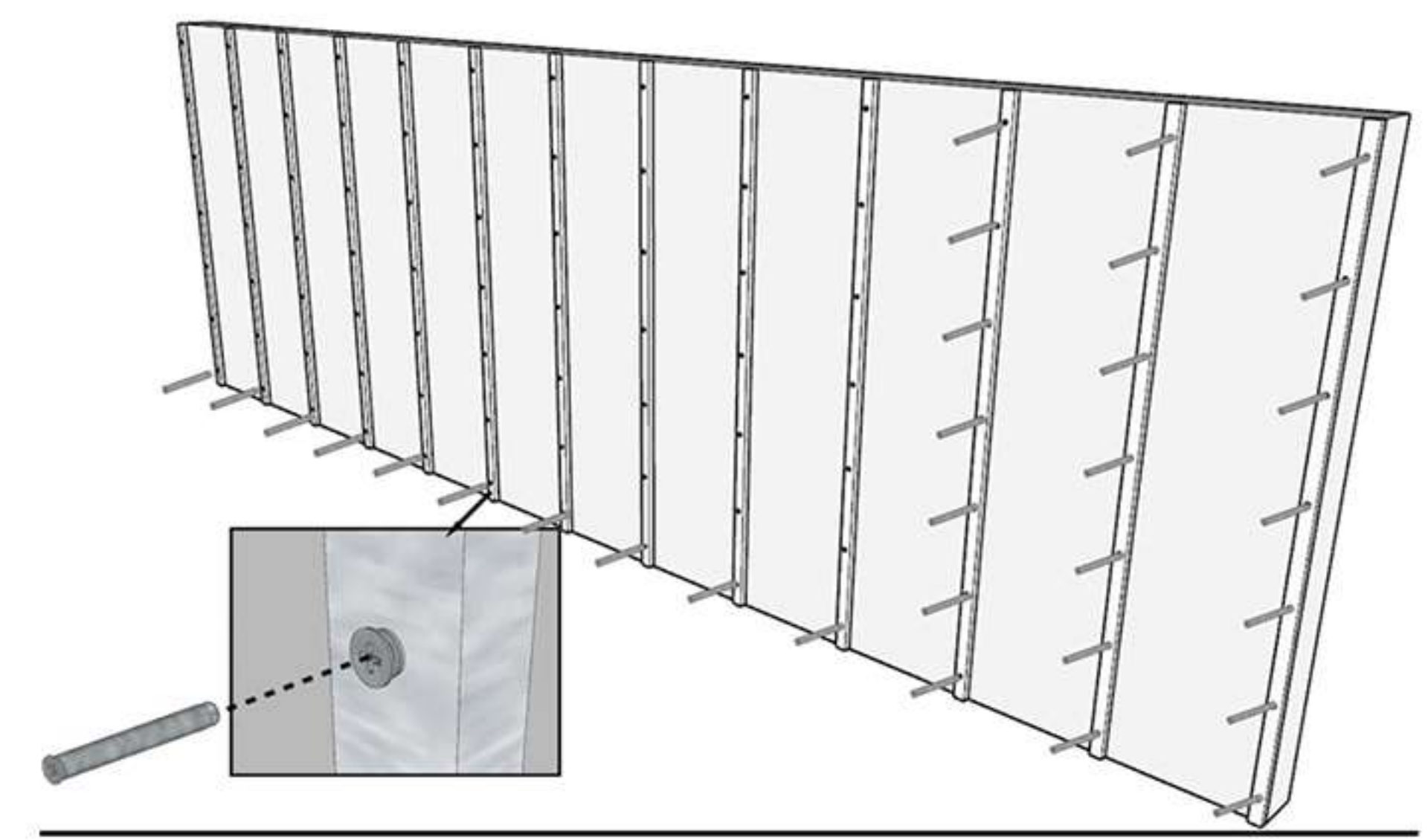

STEP 01

Measure the area carefully to determine the amount of cladding needed. Cut the panels to the required size using a saw if necessary.
Fix the aluminum joists on the wall with screws.
The recommended distance between the aluminum joists is 600mm

STEP 02

Install a starter strip at the bottom of the wall to support the first row of panels. Use screws or nails to secure it in place.
The first row clips are 5mm from the ground

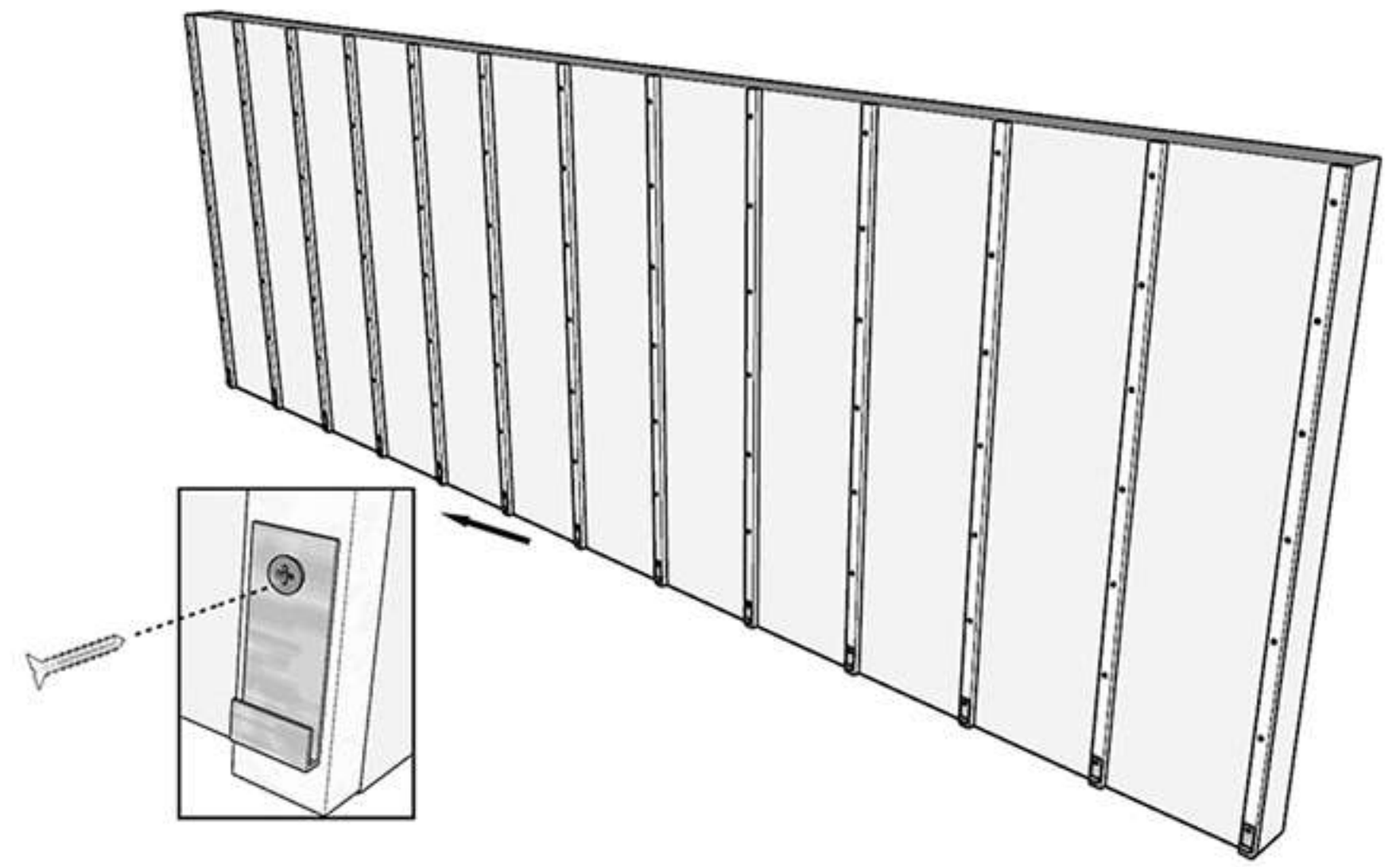

STEP 03

Install the first wall cladding on the aluminum joists with screws

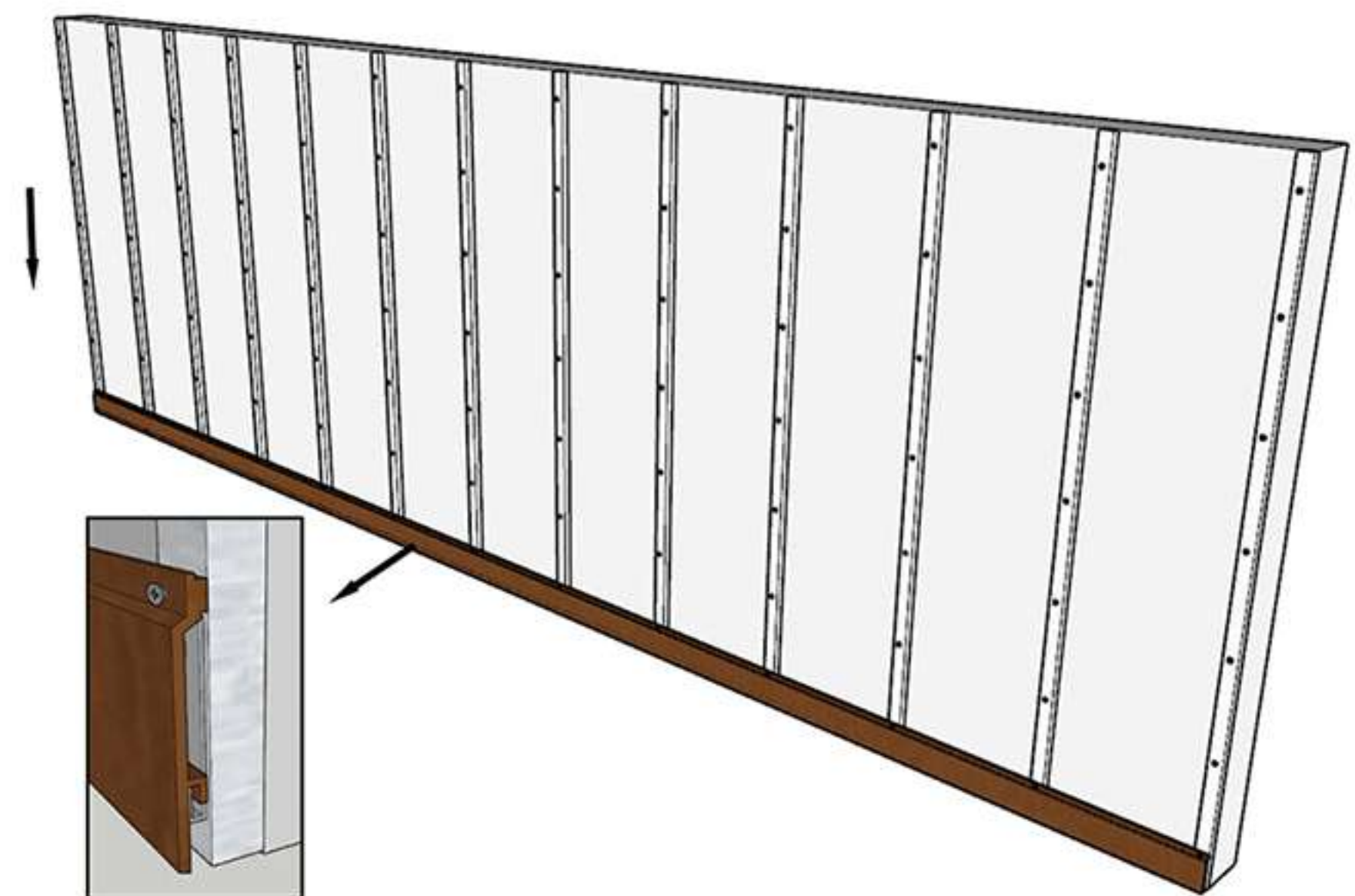

STEP 04

Install the wpc wall panels one by one

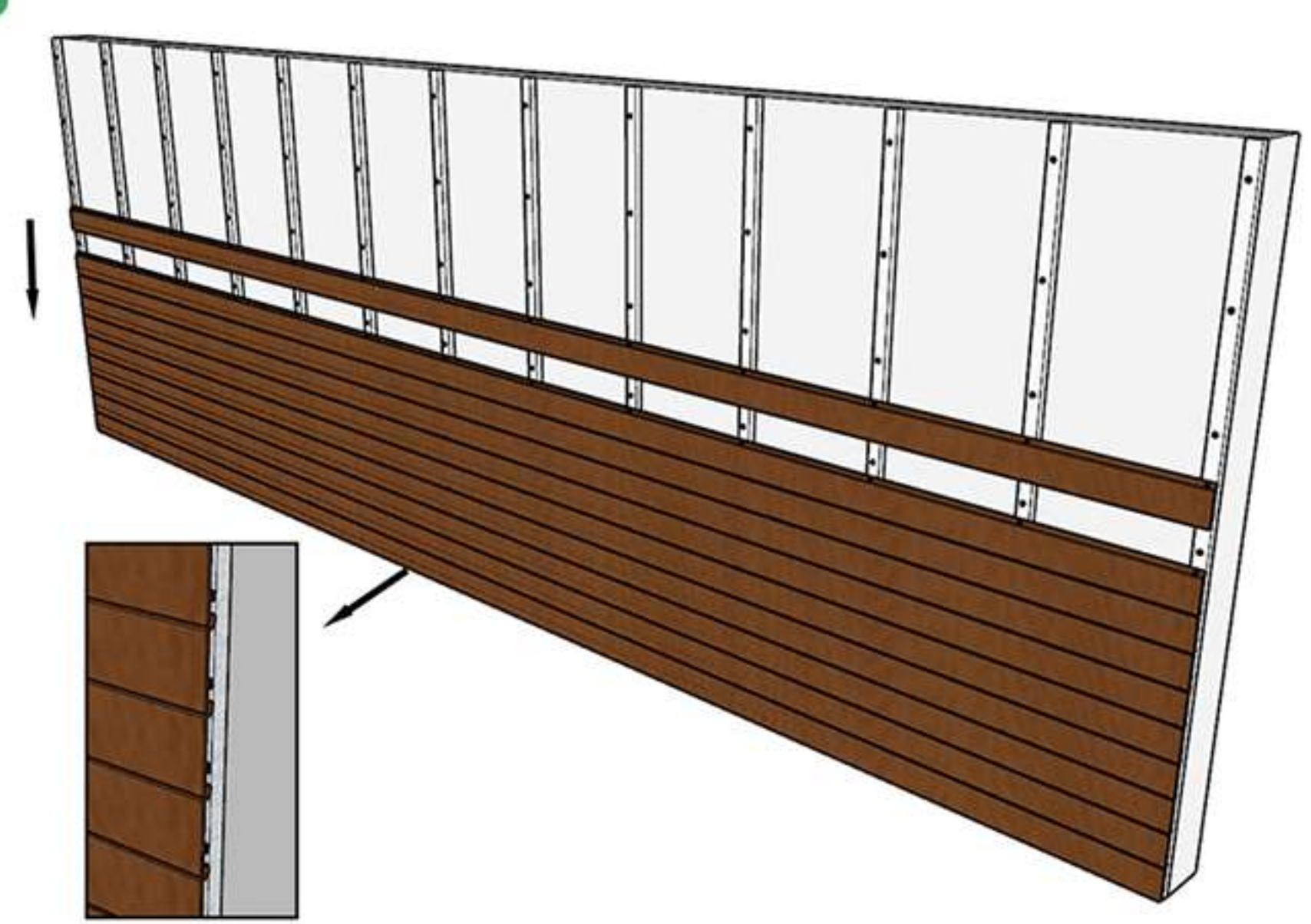

STEP 05

All the WPC wall panels are installed.

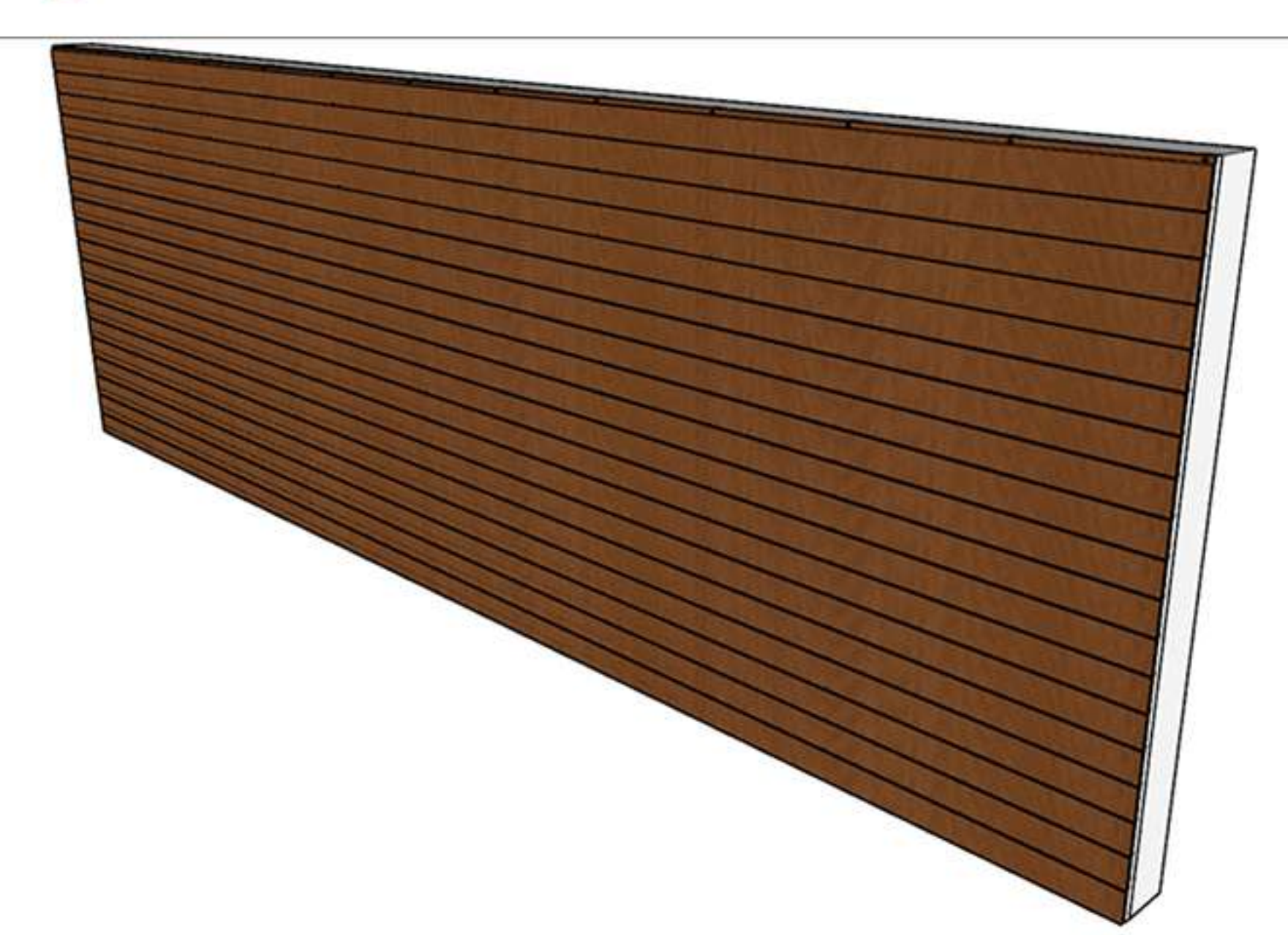

STEP 06

Install finishing trims around the edges and corners to give the installation a polished look. Secure the trims with adhesive or screws.

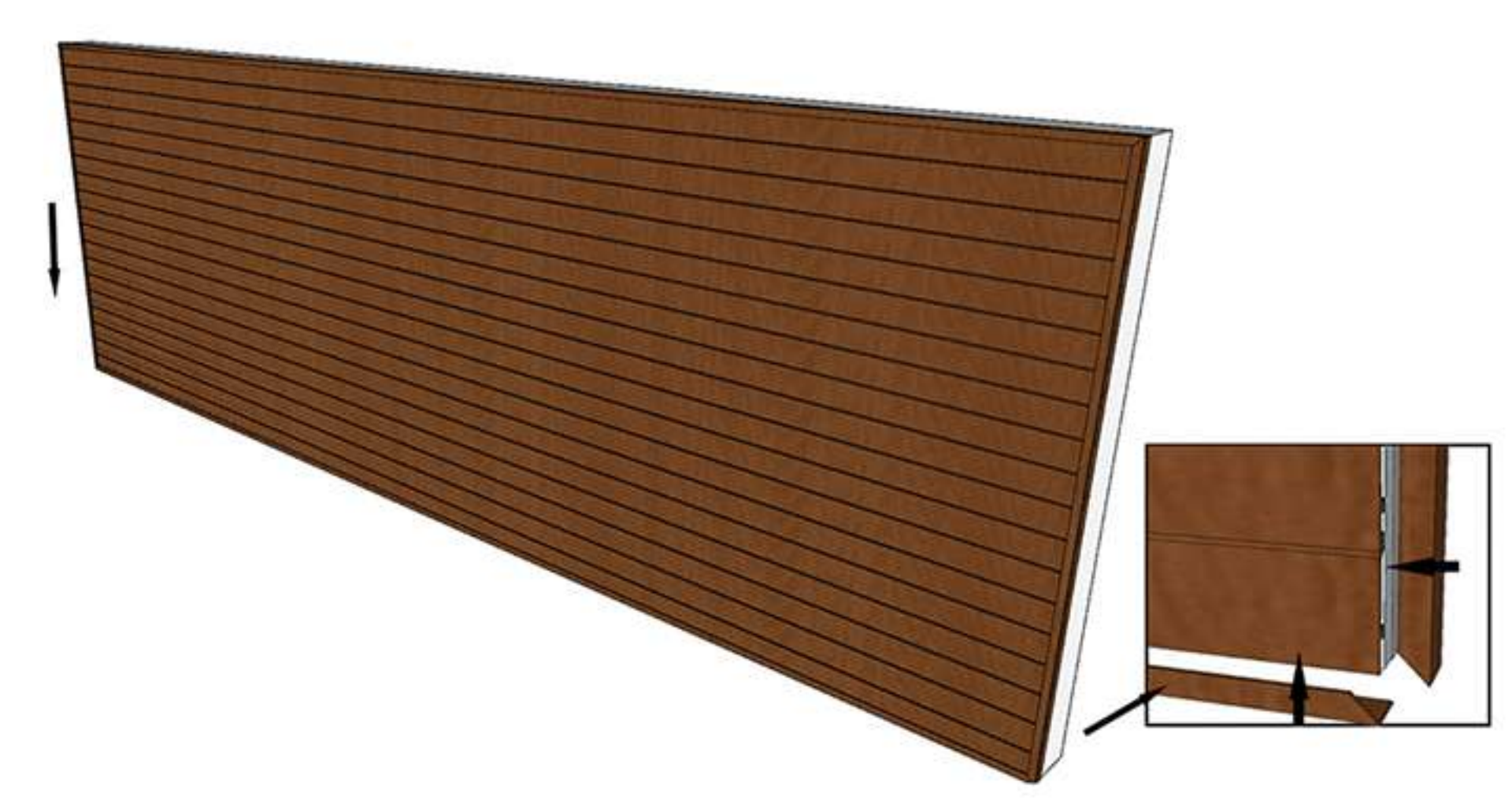

STEP 07

The WPC wall panel installation is completely finished. Always refer to the specific installation instructions provided by the manufacturer for the best results.

